

Big Blue® 800 Duo Air Pak™ Diesel Engine-Driven Welder/ AC Generator/Air Compressor

Quick Specs



Heavy Industrial Applications

Mining Maintenance
Railroad Maintenance
Maintenance and Repair Rigs

Processes

Stick (SMAW)
MIG (GMAW)
Flux-Cored (FCAW)
DC TIG (GTAW)
Submerged Arc (SAW)
Stud Welding — 1/2 inch (13 mm)
Air Carbon Arc (CAC-A)
1/2-inch (13 mm) carbons
Air Plasma Cutting and Gouging
with optional Spectrum models
Compressed Air

Output Range

Single weld mode CC: 40–800 A, CV: 14–40 V
Dual weld mode CC: 20–400 A, CV: 14–40 V

Air Compressor

100 PSI, 60 CFM, 100% duty cycle

Generator Output Rated at 104° F (40° C)

3-Phase 27,000 watts peak, 20,000 watts continuous
1-Phase 15,000 watts peak, 12,000 watts continuous

Accu-Rated™ – Not Inflated Generator Power

More power. 33 percent increase in rated output equals 800 amps of weld power and 27,000 watts of generator power.

Multi-arc welding. One dependable engine — two independent arcs with up to 400 amps each. Or plug in additional inverters for a true multioperator work platform! Example: Two additional XMTs equals four operators, up to 200 amps each. Premium quality arcs allow operators to work independently with no arc interaction. Multioperator welding has never been easier or more versatile.

Increased efficiency. More arcs and better fuel economy equal increased profits for your business. Estimated savings are 34 percent with a dual-operator unit versus two single-operator units.

Remote oil drain for engine and compressor prevents spills and makes servicing easy.

Electronic engine display simultaneously displays fuel level, engine hours, coolant temperature, oil pressure, battery volts, engine RPM, air pressure, and compressor hours. Also tracks oil change intervals and displays engine diagnostics for quick and easy servicing.



The Vault — ultimate control board reliability. See page 4.

Vandalism lockout not shown, see inset at right.



BUILT TOUGH

New!

T4F COMPLIANT

TRUE BLUE
3YR. WARRANTY

Heavy-duty low-speed T4F and T4i industrial diesel engines.
DEUTZ The cleanest, greenest diesel power available. Utilizes Diesel Oxidation Catalyst (DOC) technology in T4F models to keep the air clean with **NO** exhaust aftertreatment maintenance.

Ingersoll Rand ultra-reliable industrial rotary screw compressor. 30,000-hour life expectancy. Independent on/off control for applications not requiring compressed air — allows greater fuel savings and longer compressor service intervals.

Low OCV Stick reduces the open-circuit voltage to 15 volts when the welding power source is not in use, increasing operator safety without compromising arc starts.

Infinite arc control allows the arc characteristics to be changed for specific applications in Stick, MIG and FCAW.

Auto Remote Sense™ (ARS) detects if a remote control is plugged into the 14-pin receptacle and eliminates confusion of a remote/panel switch.

Thermal overload protection prevents machine damage if the duty cycle is exceeded or airflow is blocked.

Standard features include digital weld meters, automatic idle, 120 V block heater, lockout/tagout battery disconnect switch and vandalism lockout (protects control panel and receptacles).



Welder/generator/air compressor is warranted by Miller for 3 years, parts and labor.
Engine is warranted separately by engine manufacturer.



Miller Electric Mfg. Co.
An ITW Company
1635 West Spencer Street
P.O. Box 1079
Appleton, WI 54912-1079 USA

Equipment Sales US and Canada
Phone: 866-931-9730
FAX: 800-637-2315
International Phone: 920-735-4554
International FAX: 920-735-4125

MillerWelds.com
  



Specifications (Subject to change without notice.)



Weld Mode/ Process	Output Mode	Weld Output Range	Weld Output Rated at 104° F (40° C)	Max. Open-Circuit Voltage	Generator Power Output Rated at 104° F (40° C)***	Sound Levels at 23 ft. (7 m)	Dimensions	Weight
CC/DC (Stick/TIG)	Separate (Dual Outputs)	20–400 A	400 A at 36 V, 100% Duty Cycle* (Each Side)	85 VDC 15 VDC**	3-phase: 27,000 watts peak, 20,000 watts continuous 1-Phase: 15,000 watts peak, 12,000 watts continuous	Idle: 71.3 dB (96.1 Lwa), 75.3 dB at one meter from front panel Weld (800 A Load): 78.9 dB (103.7 Lwa), 82.8 dB at one meter from front panel	H: 46 in. (1168 mm) H: 53.5 in. (1359 mm) (to top of exhaust) W: 28.5 in. (724 mm) D: 69.5 in. (1765 mm)	Net: 2095 lb. (968.4 kg) Ship: 2146 lb. (991.6 kg) Additional 165 lb. (75 kg) when fuel tank is full
	Paralleled (Combined)	40–800 A	700 A at 44 V, 100% Duty Cycle* 800 A at 38 V, 100% Duty Cycle					
CV/DC (MIG/FCAW)	Separate (Dual Outputs)	14–40 V	400 A at 34 V, 100% Duty Cycle* (Each Side)					
	Paralleled (Combined)	14–40 V	750 A at 40 V, 100% Duty Cycle* 800 A at 38 V, 100% Duty Cycle					

*Meets NEMA and IEC ratings. **Sense voltage for Stick and Lift-Arc™ TIG. ***Will operate either 60 Hz or 50/60 Hz power tools, lights, etc.

Certified by Canadian Standards Association to both the Canadian and U.S. Standards.

Engine Specifications (Engines warranted separately by the engine manufacturer.)

Engine Brand	Features	HP	Type	Engine Speeds	Capacities	Automatic Engine Shutdown
USA Deutz TD2.9 L4	EPA Tier 4 Final compliant	65.7	Turbo-charged four-cylinder, liquid-cooled industrial diesel	Idle: 1350 RPM Weld: 1800 RPM	Fuel: 25 gal. (95 L) Oil: 8.5 qt. (8 L) Coolant: 16 qt. (15.2 L)	Low Oil Pressure, High Coolant Temperature, Low Fuel Level
Int'l Deutz TD2011L04o	EPA Tier 4i compliant	63.4	Turbo-charged four-cylinder, liquid-cooled industrial diesel	Idle: 1350 RPM Weld: 1800 RPM	Fuel: (95 L) 25 gal. Oil: (10.4 L) 11 qt. Coolant: Integrated Oil	Low Oil Pressure, High Coolant Temperature, Low Fuel Level

Air Compressor

Compressor Brand	Features	Free Air Delivery	Working Pressure Constant	Duty Cycle	Oil Capacity	Automatic Compressor Shutdowns
Ingersoll Rand CE55 G1	Rotary screw with electric clutch for on/off. Oil change intervals of 500 hours. Life expectancy of 30,000 hours.	Idle: 40 CFM (1.13 m³/min.) Weld: 60 CFM (1.70 m³/min.)	100 PSIG (7 bar)	100%	4 qt. (3.79 L)	Oil Temperature

Performance Data

FUEL CONSUMPTION CURVE

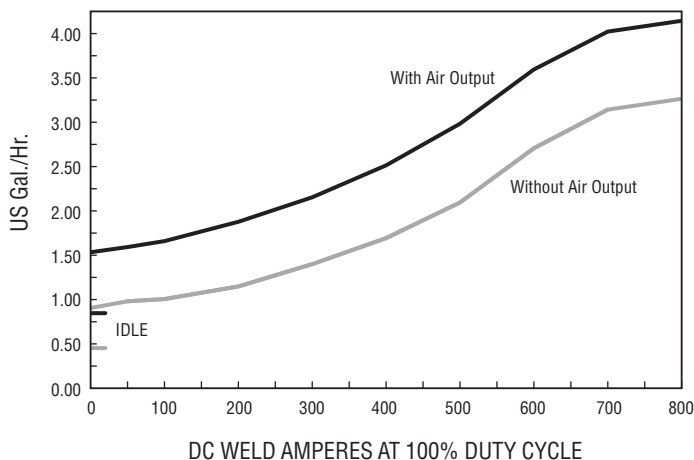

SIMULTANEOUS WELDING AND POWER

Weld Amperes	Total Aux. Power Available (Watts)	
	1-Phase*	3-Phase
No Weld Output	16,000	20,000
200 A at 28 V	16,000	20,000
300 A at 32 V	16,000	20,000
400 A at 36 V	16,000	18,000
500 A at 40 V	14,000	12,500
600 A at 40 V	10,500	8,700
700 A at 44 V	6,500	0
800 A at 44 V	4,000	0

*Single-phase listings include 4000 watts from the exciter stator.

Function Guide

- Operator Controls.** Independent controls for multi-arc welding. "A" controls are for single operator and "B" controls are for a second operator.
- Self-Calibrating Digital Weld Meters with Fault Code Indication** display preset or actual weld parameters.
- Adjustable Arc Control** adjusts DIG when process control is in Stick mode and adjusts inductance when process control is in FCAW or MIG mode. The amount of DIG determines how much amperage (heat) varies with Stick arc length. Inductance determines the "wetness" of the weld puddle.
- Amperage/Voltage Adjust Control**
- Hot Start™** provides positive Stick electrode starts for easy starts on all electrode types and it also works great for bead tie-ins.
- Great FCAW/MIG Performance and Arc Starts** make the Big Blue® 800 Duo Air Pak's arc best in its class. Easy to run all wires from .023-inch solid wires to large diameter 1/8-inch flux-cored wires.
- Lift-Arc™ TIG with Auto-Stop™.** See page 4 for benefits.
- Electronic Engine Display** can display fuel level, engine hours, coolant temperature, oil pressure, battery volts, engine RPM, air pressure, and compressor hours simultaneously or one at a time. Also tracks oil change intervals and displays engine diagnostics for service technicians.
- Air Compressor On/Off Switch**
- Engine Control Switch** is used to start engine and then select between Auto Idle and High Speed Lock. Glow plug operation is controlled by the engine control module and automatically occurs as needed by ambient conditions.
- Standard 14-Pin Receptacle** for simple connection of remote controls and wire feeders. Includes **Auto Remote Sense™** which automatically switches from panel to remote amperage/voltage (A/V) control with remote connected. Eliminates confusion of a panel/remote switch.
- Weatherproof Lexan® Nameplate** is super durable and resists cracking and fading. Color coded for ease of operation.
- Separate/Parallel Switch.** Use switch to select single operator mode (A) or dual operator mode (A/B).
- Weld Output Terminals**

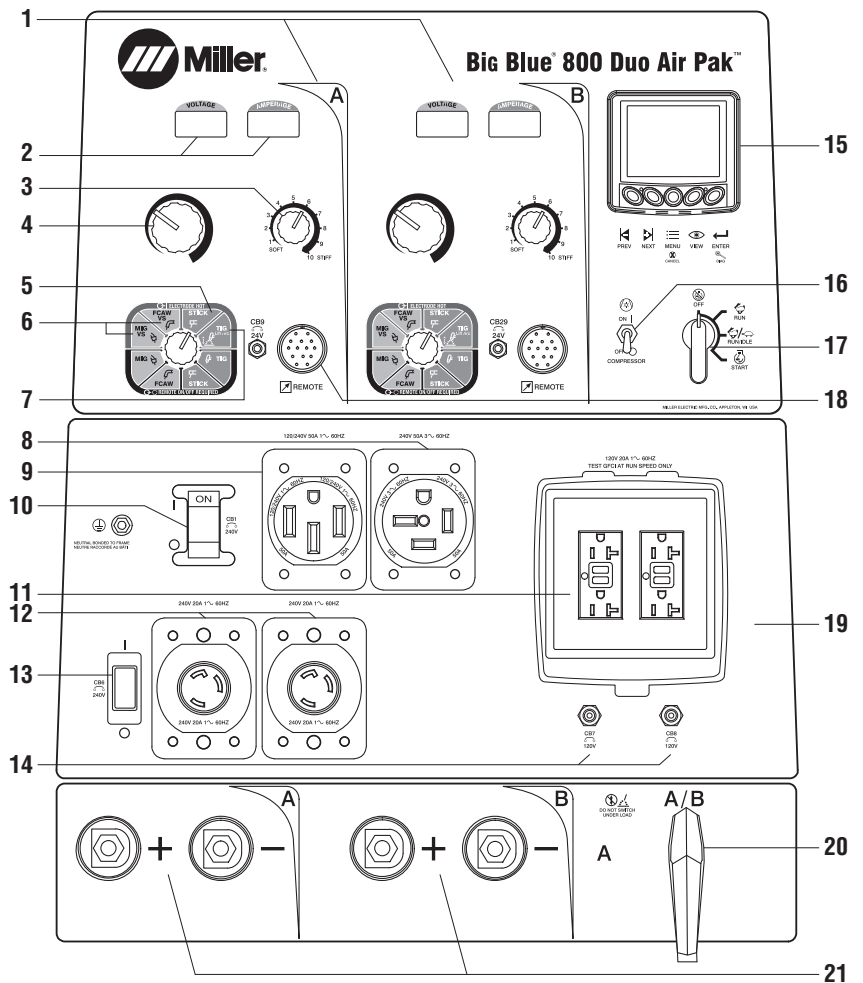

USA Model

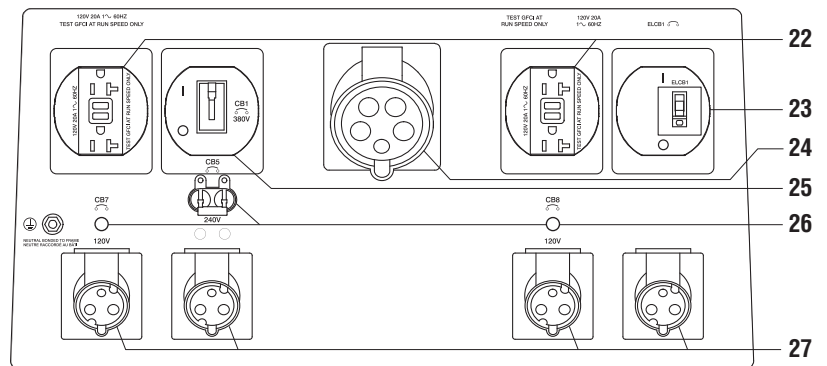

International Model Receptacles and Circuit Breakers

USA Model Receptacles and Circuit Breakers

- 50 A, 240 V, Three-Phase Receptacle**
(For matching plug, order #254 140.)
- 50 A, 120/240 V Receptacle** (For matching plug, order #119 172.)
- 50 A Circuit Breaker**
- 20 A, 120 V Receptacles with Ground Fault**
- 20 A, 240 V Receptacles**
- 20 A, 240 V Circuit Breaker**
- 20 A, 120 V Circuit Breakers**

International Receptacles and Circuit Breakers

- 20 A, 120 V Receptacles with Ground Fault**
- 240 V Earth Leakage Circuit Breaker**
- 32 A, 400 V Three-Phase Receptacle**
(For matching plug, order #255 421.)
- 30 A, Three-Phase Circuit Breaker**
- 120 and 240 V Circuit Breakers**
- 16 A, 120/240 V Receptacles**
(For matching plugs, order #255 419 for 120 V and #255 416 for 240 V.)

Welder Truck Specific Models

The Big Blue 800 Duo Air Pak is available in welder truck specific models, which have the critical controls and side A controls located within easy reach of a ground-based operator when the machine is mounted on the bed of a large-body truck. This version also includes standard hardware upgrades including air cleaner restriction indicators, FA-1D Lockable Flame Arrestor Fuel Cap (#043 947), and Spark Arrestor (#195 021). The rear-mounted Desiccant Air Dryer System (#195 117-00-11236) is available as a factory option.

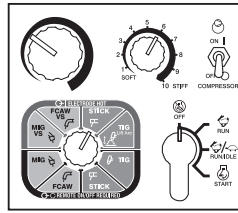

The lower control panel has the following controls: Process Selection Control, Adjustable Arc Control, Amperage/Voltage Adjust Control, Air Compressor On/Off Switch and Engine Control Switch. For more information, see descriptions in the Function Guide on page 3.

Lift-Arc™ TIG with Auto-Stop™

ARC START with Lift-Arc™

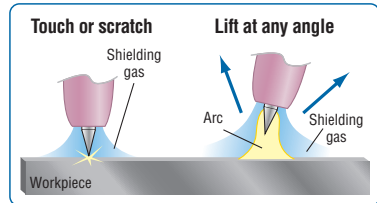

- Reduces or eliminates sticking
- Reduces or eliminates electrode/work contamination
- Low open-circuit voltage

ARC END with Auto-Stop™

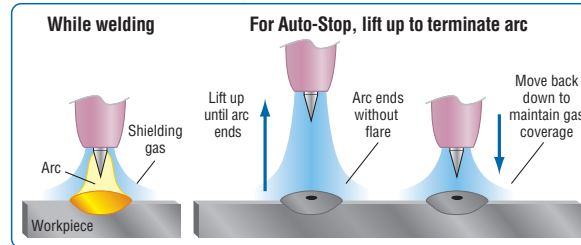

- Eliminates need for a remote control
- Maintains shielding gas coverage
- Eliminates tungsten and workpiece contamination
- Eliminates unwanted arc strikes outside the weld area

What Makes Miller® Industrial Engine Drives So [TOUGH]?

Superior Circuit Board Design

Our critical circuit boards are engineered to carry *low power* and *low heat* to reduce thermal stress and minimize expansion and contraction. In contrast, our competitor's boards carry *high power* and *high heat*, making them more vulnerable to failure.

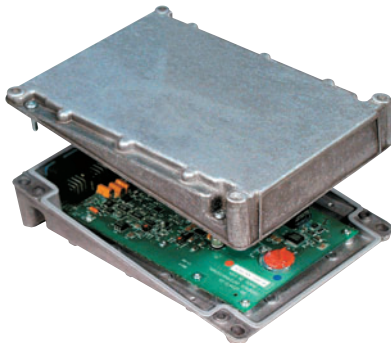

“The Vault” Makes Upgrading to Miller CC/CV Units Worry-Free

Concerns with circuit board reliability have resulted in some operators steering clear of CC/CV welder/generators—even though they offer a superior arc and multiple welding processes. Miller circuit board reliability isn't a concern since all Big Blue multiprocess industrial engine drives feature the Vault.

Created out of two aluminum halves sealed with silicone, as well as watertight harness connections, the Vault provides a clean circuit board environment, protecting the electronics—and controlling output—in heavy industrial applications. No other competitor protects their electronics with a sealed vault, leaving critical circuit boards exposed to harsh elements that can disrupt the machine's electronics, and therefore, its operation.

Rigorous Testing for Tough, Real-World Conditions

To prove our machines go to the limit, Miller industrial engine drives are put to the test in very extreme environmental conditions.

- **Airborne dust and sand.** Critical components are exposed to abusive airborne particles in a special testing chamber for weeks, helping make sure they'll operate while facing extreme levels of dirt, dust or sand on the jobsite.
- **Humidity and corrosion.** Inside our Houston testing room, critical components are subjected to extended moisture and corrosive salt exposure to ensure they'll run even when exposed to humid climates, corrosive coastal environments, and driving rain.
- **Temperature extremes.** Miller industrial engine drives are tested to ensure performance in scorching heat. All Miller engine-driven machines are weld rated at 104 degrees Fahrenheit, but actual tests are conducted up to 122 degrees Fahrenheit to assure peak performance.
- **Jobsite/over-the-road abuse.** Miller industrial engine drives are shaken for hours on transportation bed simulators, subjected to severe vibration, and test-dropped and jerked to ensure they'll withstand the stresses that can shut down competitive machines.
- **Continuous operation.** Miller industrial engine drives run day and night, in all weather conditions, to assure they'll perform without interruption in the field.



Why Industrial Engine Drive Customers Choose Miller

The ultimate test of Miller reliability is how it performs in the field. Read stories demonstrating our superior reliability at MillerWelds.com.



Genuine Miller® Accessories

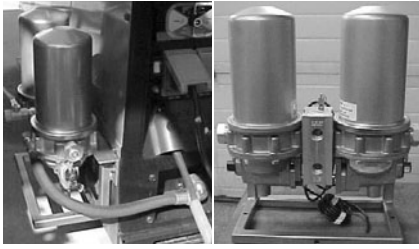

Desiccant Air Dryer System

#195 117 Side mount

#195 117-00-11236 Rear mount

A regenerating inline air dryer system that eliminates moisture in the air stream to prevent air tool freeze-ups in cold climates. Internal thermostat and heating elements ensure good air quality in all climates. The system can be mounted on the side or on the rear of the machine to meet your installation requirements.



Female
Receptacle



Adapter Cord, Full KVA #300 517 Field
NEMA 14-50P to NEMA 6-50R. Adapts engine drive 120/240 V plug to common Millermatic® and Spectrum® 240 V plug.



Full KVA Plug Kit

Field
#119 172 1-Phase,
120/240 VAC, 50 A plug
(NEMA 14-50P)

#254 140 3-Phase,
240 VAC, 50 A plug
(NEMA 15-50P)



International Plugs

Field
#255 419 1-Phase,
120 VAC, 16 A plug

#255 416 1-Phase,
240 VAC, 16 A plug

#255 421 3-Phase,
400 VAC, 32 A plug

Deutz Engine Filter Kit #262 459 Field
Includes all filters required for proper engine maintenance. Oil filter, primary and secondary fuel filter, and primary air filter.

Compressor Filter Kit #246 991 Field
Includes all filters required for proper compressor maintenance. Oil filter, air filter and coalescing filter.



Spark Arrestor Kit

Field
#195 012
Prevents particles
from leaving the
muffler that could

potentially start a fire. Mandatory when operating on California grasslands, brush, or forest-covered land, and in all National Forests. For other areas, check your state and local laws. Meets U.S. Forest Service standard 5100-1B.



FA-1D Lockable Flame Arrestor Fuel Cap #043 947 Field
Fuel cap can be padlocked to prevent vandalism. A built-in flame arrestor prevents flames or sparks from entering the fuel tank.



Cable Holder

Field
#043 946
Saddle-bag-style cable holder. Convenient wrap-around storage of coiled cable for transportation. Stores 100 feet of 2/0 cable on each side.

Note: For best results do not weld when cable is coiled! Protective cover cannot be used with cable holder.



Protective Cover

Field
#301 113
Blue water-resistant canvas cover resists stains and mildew, and protects the finish of your welder.

Note: Protective cover cannot be used with cable holder.

Stick (SMAW) Welding

Weld Leads

2/0 Stick Cable Set, 50 ft. (15 m) #173 851
Consists of 50-foot (15 m) 2/0 electrode cable with holder, and 50-foot (15 m) work cable with clamp. 350 A, 100% duty cycle.

2/0 Stick Cable Set, 100/50 ft. (30.5/15 m) #043 952

Consists of 100-foot (30.5 m) 2/0 electrode cable with holder, and 50-foot (15 m) work cable with clamp. 300 A, 100% duty cycle.

MIG (GMAW) or Flux-Cored (FCAW)



SuitCase® X-TREME™ 8VS Wire Feeder #951 582

SuitCase® X-TREME™ 12VS Wire Feeder #951 543

Lightweight, voltage-sensing wire feeders include secondary contactor, gas valve and drive roll kit. See Lit. Index No. M/6.42.



SuitCase® 12RC Wire Feeder #951 580

Lightweight and flexible enough to run a variety of wires up to .062-inch diameter. Includes remote voltage control and drive roll kit. See Lit. Index No. M/6.5.



Spoolmatic® 30A Spool Gun #130 831
Air-cooled, 200-amp, one-pound spool gun for aluminum MIG. See Lit. Index No. M/1.73.

WC-24 Control #137 549

Use with Spoolmatic 30A.

XR™ Wire Feeders and Guns

Push-pull system designed to handle difficult-to-feed soft alloy wires such as aluminum. See Lit. Index Nos. M/1.7 – M/1.75.

MIG (GMAW)/Flux-Cored (FCAW) Guns

Miller produces a complete line of dependable MIG guns. See Lit. Index Nos. AY/15.0, AY/16.0 and AY/17.0.

TIG (GTAW) Welding



Dynasty® 200 Series
For premium portable AC/DC TIG arc quality. See Lit. Index No. AD/4.8.

Genuine Miller® Accessories (Continued)

Plasma Cutting



Spectrum 375 X-TREME and 625 X-TREME shown.

Spectrum® 375 X-TREME™ #907 529

See Lit. Index No. PC/9.2.

Spectrum® 625 X-TREME™ #907 579

See Lit. Index No. PC/9.6.

Spectrum® 875 #907 583

See Lit. Index No. PC/9.8.

The Spectrum 375 X-TREME and 625 X-TREME come complete with protective X-CASE™ (not shown).

Remote Controls



Wireless Remote Hand Control #300 430

For remote current, voltage and contactor control. Receiver plugs directly into the 14-pin receptacle of Miller machine. 300-foot

(91.4 m) operating range. Wireless Antenna Kit #300 749 recommended.

Wireless Antenna Kit #300 749

Optional when improved reception is desired.



RHC-14 Hand Control #242 211 020

Miniature hand control for remote current, voltage and contactor control. Dimensions: 4 x 4 x 3.25 inches (102 x 102 x 82 mm). Includes 20-foot (6 m) cord and 14-pin plug.

Extension Cables for 14-Pin Remote Controls or 24 VAC Wire Feeders

#242 208 025 25 ft. (7.6 m)

#242 208 050 50 ft. (15.2 m)

#242 208 080 80 ft. (24.4 m)

Trailers and Hitches (Note: Trailers are shipped unassembled.)

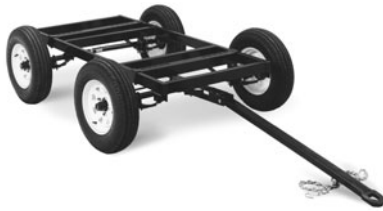

4 West Four-Wheel Steerable Off-Road Trailer #042 801

A heavy-duty 2570-pound (1166 kg) capacity trailer designed for use in mines, quarries, and other rough terrain. Has narrow 22-foot (6.7 m) turning radius. Includes 3-inch (76 mm) lunette eye, universal hitch and safety chains.



HWY-224 Trailer

#043 805 For highway use.

OFR-224 Trailer

#043 802 For off-road use.

A 2650-pound (1202 kg) capacity trailer. Welded steel tubing frame, heavy-duty axle with roller bearing hubs and leaf-spring suspension. Includes jack stand and 2-inch (50 mm) ball hitch. *HWY-224 also includes fenders and lights.*

Cable Tree #043 826

Provides an area to conveniently wrap weld cables and extension cords.



Dual Hitch #300 831

2-inch (50 mm) ball hitch and 3-inch (76 mm) lunette eye in one reversible assembly.

Mounting Specifications

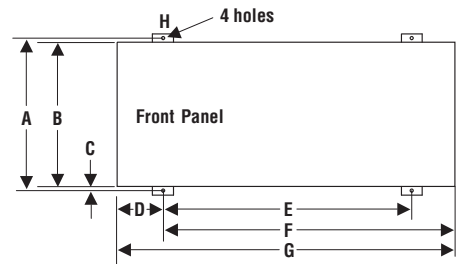

A. 29.812 in. (757 mm)

B. 27.5 in. (699 mm)

C. 1 in. (25 mm)

D. 9.625 in. (244 mm)*

E. 46.5 in. (1181 mm)*

F. 56 in. (1422 mm)*

G. 69.5 in. (1765 mm)

H. .562 in. (14 mm) diameter

Height: 45.5 in. (1156 mm) to top of cover

55 in. (1397 mm) to top of exhaust

(exhaust measurement subject to change)

Width: 28.5 in. (724 mm)

(mounting brackets turned in)

30.75 in. (781 mm)

(mounting brackets turned out)

*With mounting brackets in center position.

Dimensions vary with location of mounting brackets.

Trailer Specifications (Subject to change without notice.)

Model	Gross Axle Weight Rating	Gross Vehicle Weight Rating	Net Payload	Height of Bed	Road Clearance	Track (Center to center of tires)	Standard Tires (Standard rating or P-size rating)	Dimensions	Net Weight
4 West	2000 lb./axle (907 kg/axle)	3000 lb. (1361 kg)	2570 lb. (1166 kg)	21.25 in. (540 mm)	8 in. (203 mm)	55.25 in. (1403 mm)	B78-13	Length: 91 in. (2311 mm)* Width: 61.25 in. (1556 mm)	430 lb. (195 kg)
HWY-224 OFR-224	3500 lb. (1588 kg)	2960 lb. (1343 kg)	2650 lb. (1202 kg)	18.5 in. (470 mm)	7.25 in. (184 mm)	52 in. (1321 mm)	B78-13	Length: 105 in. (2667 mm) Width: HWY-59.5 in. (1511 mm)** OFR-58.438 in. (1484 mm)	320 lb. (145 kg)

*Does not include tongue. **Width at outside of fenders.

Typical Installations

Electrode Hot



Stick (SMAW) Basic Equipment
RHC-14 #242 211 020
Wireless Remote Hand Control #300 430
Wireless Antenna Kit #300 749

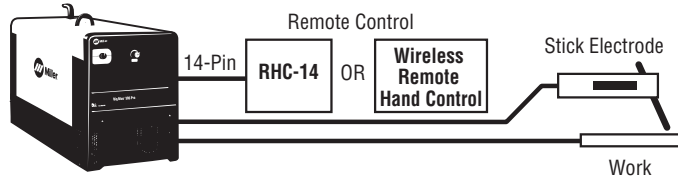

Flux-Cored/MIG (FC) Basic Equipment
SuitCase® X-TREME™ 8VS #951 582
SuitCase® X-TREME™ 12VS #951 543

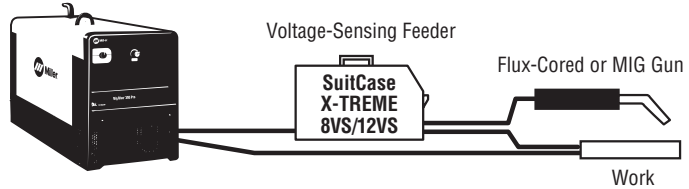

Lift-Arc™ TIG (GTAW) Basic Equipment

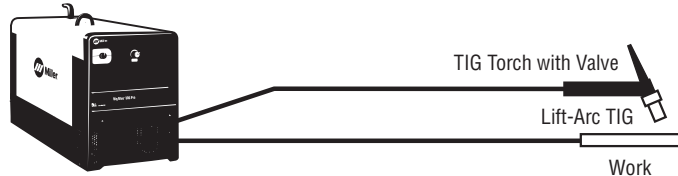

Remote On/Off Required



Stick (SMAW) Basic Equipment
RHC-14 #242 211 020
Wireless Remote Hand Control #300 430
Wireless Antenna Kit #300 749

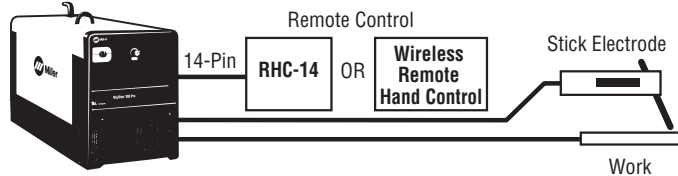

Flux-Cored/MIG (FC) Basic Equipment
SuitCase® 12RC #951 580

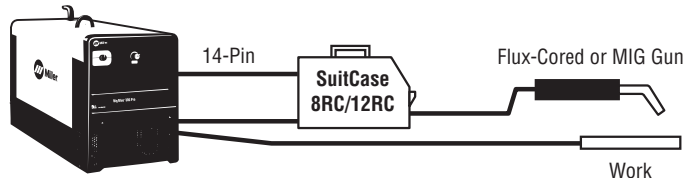

Aluminum MIG (GMAW) Basic Equipment
Spoolmatic® 30A #130 831
WC-24 #137 549

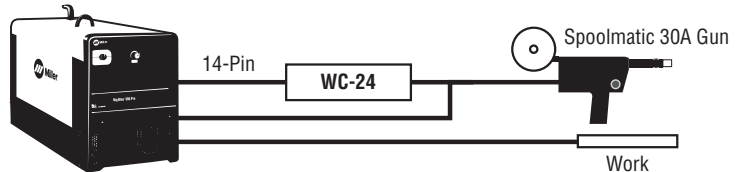

Plasma Basic Equipment
Spectrum® 375 X-TREME™ #907 529
Spectrum® 625 X-TREME™ #907 579
Spectrum® 875 #907 583

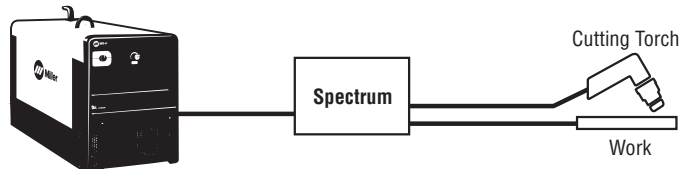

Multioperator Basic Equipment
 Expand standard multioperator capabilities by adding up to two additional Miller inverters.

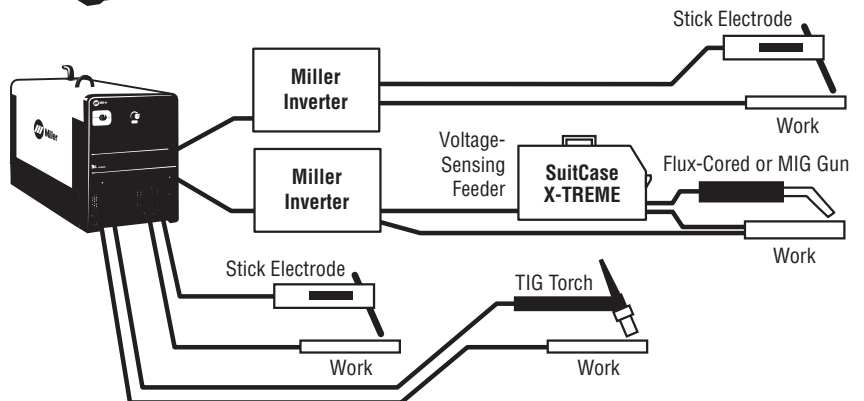

Ordering Information

Equipment and Options	Stock No.	Description	Qty.	Price
Big Blue® 800 Duo Air Pak (USA) EPA Tier 4 Final Compliant Engine	#907 535 #907 535-002 #907 535-003	Base model with 240-volt 3-phase power. Includes Vandalism Lockout Welder truck specific model. See page 4 for more information Welder truck specific model with rear-mounted Desiccant Air Dryer System		
Big Blue® 800X Duo Air Pak (Int'l) EPA Tier 4i Compliant Engine	#907 536	International model with 400-volt 3-phase power		
Big Blue® 800CA Duo Air Pak (Int'l) EPA Tier 4i Compliant Engine	#907 634	Canadian/Central American model with 240-volt 3-phase power		
Field Accessories				
Desiccant Air Dryer System	#195 117 #195 117-00-11236	Side mount Rear mount		
Adapter Cord, Full KVA	#300 517	Field		
Full KVA Plug Kit	#119 172 #254 140	Field. 1-phase, 120/240 VAC, 50 A Field. 3-phase, 240 VAC, 50 A		
International Plugs	#255 419 #255 416 #255 421	Field. 1-phase, 120 V, 16 A Field. 1-phase, 240 V, 16 A Field. 3-phase, 400 V, 32 A		
Deutz Engine Filter Kit	#262 459	Field. Includes air, oil and fuel filters		
Compressor Filter Kit	#246 991	Field. Includes air, oil and coalescing filters		
Spark Arrestor Kit	#195 012	Field		
FA-1D Lockable Flame Arrestor Fuel Cap	#043 947	Field. Padlock NOT included		
Cable Holder	#043 946	Field. Stores up to 200 feet of 2/O cable		
Protective Cover	#301 113	Field. Canvas cover — will not fit over machine with Cable Holder attached		
Stick Welding Leads	#173 851 #043 952	2/O, 350 A, 100% duty cycle, 50-ft. (15 m) stinger, 50-ft. (15 m) work clamp 2/O, 300 A, 100% duty cycle, 100-ft. (30.5 m) stinger, 50-ft. (15 m) work clamp		
Flux-Cored/MIG Welding				
SuitCase® X-TREME™ 8VS	#951 582	See Lit. Index No. M/6.42		
SuitCase® X-TREME™ 12VS	#951 543	See Lit. Index No. M/6.42		
SuitCase® 12RC	#951 580	See Lit. Index No. M/6.5		
Spoolmatic® 30A Spool Gun	#130 831	Requires WC-24 Control. See Lit. Index No. M/1.73		
WC-24 Control	#137 549	See Lit. Index No. M/1.5		
XR™ Wire Feeder Control and Guns		See Lit. Index Nos. M/1.7 – M/1.75		
Flux-Cored (FCAW) and MIG (GMAW) Guns		See Lit. Index Nos. AY/15.0, AY/16.0 and AY/17.0		
TIG Welding				
Dynasty® 200 Series		See Lit. Index No. AD/4.8		
Coolant System		See Lit. Index No. AY/7.2		
Plasma Cutting				
Spectrum® 375 X-TREME™	#907 529	Includes X-CASE™. See Lit. Index No. PC/9.2		
Spectrum® 625 X-TREME™	#907 579	Includes X-CASE™. See Lit. Index No. PC/9.6		
Spectrum® 875	#907 583	See Lit. Index No. PC/9.8		
Remote Controls				
Wireless Remote Hand Control	#300 430			
Wireless Antenna Kit	#300 749			
RHC-14 Hand Control	#242 211 020			
Extension Cables		See page 6		
Trailers and Hitches				
4 West Four-Wheel Steerable Trailer	#042 801	Trailer with lunette eye, universal hitch and safety chains. For off-road use		
HWY-224 Trailer	#043 805	Trailer with lights, fenders and 2-inch (50 mm) ball hitch. For highway use		
OFR-224 Trailer	#043 802	Trailer with 2-inch (50 mm) ball hitch. For off-road use		
Cable Tree	#043 826	Trailer-mounted cable holder for HWY-224 or OFR-224		
Dual Hitch	#300 831	Combination 2-inch (50 mm) ball hitch and 3-inch (76 mm) lunette eye in one reversible assembly. For HWY-224 or OFR-224		

Date:

Total Quoted Price:

Distributed by:

